

# Parish Council Newsletter

ISSUE 10 SPRING 2016



## Big Lottery awards £845,715

The largest grant ever awarded in the county for this category and the 3rd

largest in England and Wales to the Trustees of East Bedlington Community Centre.

The Parish Council are proud to have been able to support this project and help deliver a purpose built community centre in the heart of Bedlington Station .

The secured funding has now reached £1,372,043. The capital project has been hugely supported by East Bedlington Parish Council and CISWO. County Councillor Jeff Gobin has also allocated £13,000 from his small schemes fund. The Centre Trustees were successful with a bid to the Northumberland County Council Community Chest for £9,828 and Banks Community Fund who have awarded £5,000 towards fixtures and fittings.

The Trustees have appointed Brims as principal contractor and work will start in May.

The refurbished centre will expand its letting space from one room to five. The entire building will be fully accessible via an 8 person passenger lift and there will be platform lift access to the stage area. A newly created licensed community café will compliment the upper floor facilities.

The Community Centre is expanding its operations and recently acquired 15 Station Street. The Parish Council will re-locate into this building temporarily whilst the main community centre building undergoes extensive refurbishment. The refurbished Centre will re-open towards the end of 2016 for bookings.

**EAST BEDLINGTON**  
**Parish Council**



# Parish Caps Council Tax rise meaning that most

Parish sets precept at £229,480 equivalent to a Council tax of £117 for a Band D property. The precept represents an increase of £55,000 (29%) on that set for 2015/16. However, for the 82% of residents in East Bedlington living in band 'A' Properties the increase will be under £20 a year and the precept will remain one of the lowest in South East Northumberland. Parish Clerk, Ron Thornton advised that there were 3 main contributing factors to this year's increased precept;

Firstly, the need to begin to replace obsolete / worn out equipment that was inherited from predecessor authorities, secondly, the need to invest in facilities, services and activities that have been denied to our residents' over many years, and thirdly, Northumberland County Council's decision to once again withhold Council Tax support in 2016/17.

## Replacing Assets / Equipment

The Clerk advised that the renewal of play areas at Cambois and North Blyth would cost in excess of £40,000 and that the replacement of obsolete play equipment and bus shelters would cost an estimated £200,000 over the next 5 years. The current year's budget also included £9,000 for the provision of larger free standing bins to replace some of the smaller lamppost mounted ones. This will help make litter collection more efficient and free up NCC operatives time to tackle discarded litter on our streets.

## Addressing Lack of Facilities and Services

Last year we responded to the Communities aspirations by pledging £400,000 (financed over 20 years) towards the restoration of East Bedlington Community Centre, a decision which has helped secure a further £900,000 of external funding. The new Centre will be the delivery vehicle to

## News in brief ....

### Core Strategy Update

The proposed new timetable for the core strategy will see major modifications published and consulted on in June and July 2016. The final strategy will be agreed in November and submitted to Government in December 2016. This would see examination by Government in spring 2017 and adoption in summer 2017.

## Work starts on the Gallagher Park Pavilion ....

Northumberland County Council has started work on a new pavilion for Gallagher Park. The investment of around £685k has been met in part by a £135k grant from Sport England.

The facility which we understand will be managed by Active Northumberland is located on the existing play area which Active Northumberland preferred to the recommendations outlined in the Gallagher Park Masterplan.

As development of the park was identified as a high priority during our parish plan process we are please progress in now being made.

The new development is a testament to the hard work and dedication of the late George Webster and the Friends of Gallagher Park.

# residents will pay no more than £1.50 per week.....

address many of the issues identified in the parish plan including social isolation, skills deficits, lack of amenities, youth provision and employment and training opportunities. This year the Council has allocated a further £15,000 of revenue funding in addition to its capital investment.

Council Chairman, Alex Wallace commented that "by providing facilities previously only available in Ashington, Blyth and further afield we envisage that the savings to our residents in transport costs alone will be substantial. Of course the new Community Centre can't meet all our communities needs such as sports facilities and we welcome the new facilities that will be provided by Active Northumberland upon completion of the new Bedlington Community High School. Residents will then have access to the gym, sports Hall, fitness studio and 3G pitch at evenings, weekends and during school holidays. "

## Council Tax Support

Clearly the cost of addressing the above issues is substantial, and withdrawal of council tax support has impacted the council significantly due to the relatively high level of benefit claimants in our parish. The County Council's recent press release advising that "tax payers will have to pay more for less services in the future due to government cuts" will only increase pressure on the Parish Council's budget in future years.

**"The Council has punched well above its weight up to now having helped to secure more than £1 million of external funding which is more than the total precept levied in the 6 years of the Council's existence."**

**Councillor Nicola Hogarth, Chair,  
Finance Working Group**

## Inside this issue

2016/17 Precept	2	Bedlington Community High School	10	New Debt Hub	18
News in brief	2	Northumberland Live 2	12	Wartime Bedlington continued	19
Tall ships 2016	4	Cambois Gala	12	Church News	22
Memorial seating	6	Parish Plan	13	Matthew Project Food Bank	22
Neighbourhood Watch	6	What's on in the Station	12	Your Councillors	23
Garden Competition	7	Free Energy monitors	15	Parish Office Information	24
Small Grants Scheme	7	Reporting problems	16	County Councillors	24
New play areas	8	Tackling Litter	17	MP	24

# Opportunity of a lifetime



In August 2016 the Tall Ships will be visiting Blyth. A whole host of events will take place and ships will be moored up both on the Blyth and Cambois side of the river.

East Bedlington Parish Council are launching a competition to select two young people from the Parish to experience the opportunity of a lifetime by taking part in the Regatta. The race will start from Blyth and finish in Gothenburg, Sweden.

As a trainee, you will be part of the crew and get to experience the life and the tasks aboard, as well as participate in the North Sea Tall Ships Regatta. There is no requirement of previous sailing experience, all you need to bring is curiosity, gumption and the will to learn more about leadership, cooperation and communication.

Trainees will experience the thrill and adventure of life on board a Tall Ship and be involved in almost every activity on board - taking the helm, setting sails and keeping watch, washing dishes and climbing the rigging or "going aloft" is always a particular favourite!

Whilst on board trainees will meet people from different walks of life including the permanent crew who are a group of professional seafarers who will ensure they get the most from their adventure. Each day, as the trainees' experience and confidence grows, so will their involvement in the activities on board. They will have the opportunity to discover talents they never knew they possessed whilst contributing to the ultimate team working experience.

“Sail training is an adventure activity for people of all ages and abilities. It includes instruction in all aspects of sailing but its purpose goes far, far beyond this. Sail training uses the experience of being at sea principally as a means to help people learn about themselves, discover hidden strengths and talents and understand the value of working as a team. In some programmes today it forms the setting for much wider aspects of education at sea.” *Sail Training International.*

## How to apply

To take part you must be between 15 and 19 years old by the time the race starts and have a valid passport in your own name. You will need to be able to join the ship on the 26th August 2016 and remain on-board until the ship docks in Gothenburg on 6th September 2016. Flights home to Newcastle via Heathrow are included in the sponsorship.

You will not need any previous experience as full training will be given on board.

Having a disability will not exclude you from entering the competition. If you are selected the "Lord Nelson" ship has been adapted to accommodate both disabled and able-bodied volunteers.

## Commitments ... you must be able to:

- commit to the voyage and be prepared to fly back to the UK .
- commit to keeping a record—blog, diary etc. of your experience on board
- commit to feeding back to the residents living in East Bedlington about your experience
- commit to promoting the benefits of positive engagement to young people in your community

To enter please write to the parish council and tell us:-

Why you should be selected to represent East Bedlington Parish Council

How you will keep a record of your experiences on board

How you will tell local people about your experience when you return to the UK

How you will help encourage other young people to get involved in activities in the community.

We must receive your application by Tuesday 31st May 2016, when a shortlist of applicants will be invited to give a brief presentation. The two winners will be informed week commencing Monday 13th June 2016.

## Entries to be sent to:

Ron Thornton, Clerk,  
East Bedlington Parish Council,  
16 Station Street, Bedlington.  
NE22 7JN or emailed to:  
clerk@eastbedlingtonpc.org.uk



The Dar Młodzieży one of the largest ships taking part

# Memorial Seating

We are often asked to consider allowing a seat to be placed in the parish in memory of a loved one. We are pleased to confirm that we have an opportunity to locate memorial seating along the coastal pathway at Cambois and in Dene Park (Free Woods).

There is a choice of styles to accommodate budgets and the total cost includes fitting.



You will need to provide your own plaque.

For more information please contact Assistant Clerk, Jenny Tindale on 01670 828808 for email [clerk@eastbedlingtonpc.org.uk](mailto:clerk@eastbedlingtonpc.org.uk)

## Neighbourhood Watch Scheme gathers momentum

Stephen Armstrong is the Chair of Bedlington Neighbourhood Watch Scheme. The scheme covers all areas of Bedlington, Choppington, Guidepost, East & West Sleekburn, Cambois and North Blyth. Following cuts within the Northumbria Police Force, Neighbourhood Watch Co-ordinators are now responsible for running and recruiting members to this scheme.

Stephen tells us that there are already some good schemes up and running but he wants to build on this in an attempt to help make our streets and communities safer.

There are various levels at which you can get involved including starting up your own Neighbourhood Watch Scheme for your street.

If you would like to find out more about the scheme or receive advice and information please contact Stephen on 01670 825029 or email [bed.nhw@btinternet.com](mailto:bed.nhw@btinternet.com)



# East Bedlington Garden Competition 2016

Entry forms for this years competition are included in this newsletter and can also be downloaded from our website [eastbedlingtonpc.org.uk](http://eastbedlingtonpc.org.uk)

An individual trophy will be awarded to the winner of each category along with an annual shield to be held for one year. All entrants are invited to the awards evening with complimentary buffet and hospitality.



Entry forms should be returned by Friday 1st July and judging will take place week commencing Monday 11th July 2016

## **EAST BEDLINGTON PARISH COUNCIL SMALL GRANTS SCHEME**

The parish council operates a small grants scheme to support voluntary & community sector groups who are either based within the boundaries of the parish or who are based outside but still deliver a significant service to the residents of East Bedlington on a not for profit basis.

Application forms are available from the Parish Office or they can be downloaded from the Parish Council website [www.eastbedlingtonpc.org.uk](http://www.eastbedlingtonpc.org.uk)

Community Groups must have a constitution and bank account in their own name. We do not fund individuals; activities which are normally statutory provision; businesses; salaries or wages; and cannot fund retrospectively. Typical awards are between £50 and £250 and each application is considered on its merit. For more information please contact the Clerks on 01670 828808 or email [clerk@eastbedlingtonpc.org.uk](mailto:clerk@eastbedlingtonpc.org.uk)

# Parish Council invests in play...

The Parish Council took over the responsibility for play areas in East Bedlington from Northumberland County Council in 2012. Many of the play areas were at the end of their serviceable life. We have carried out some refurbishment works and replaced individual items where funds allowed over the last 3 years. We are now beginning programme of replacing play equipment on sites where we own the freehold and in locations that we are confident will not to be subject to development in the near future.

Councillor Allan Stewart, Chairman of the East Bedlington Parish Council Environment working group said "choosing the right equipment has been important especially in our coastal area. It is a huge investment and we want to make sure our investment is there for years to come. We have elected to use Robinia wood and redress the play surfaces with grass to continue a more natural theme. We feel the new equipment is exciting and meets the Play England principles of play design".

North Blyth play area is the first to be refurbished. Work will start in early May. Removal of the older equipment and installation work will take around 2 weeks to complete.





# New play area for Cambois Wembley

The existing Wembley play area has suffered constant vandalism and is currently located on land designated for re-development. The Parish Council are in the process of acquiring land from Northumberland County Council on the northern links to create a new, accessible play area. Once the new play area has been constructed the facilities located behind the derelict garage area will be decommissioned.

The Parish Council see this as a continuation of their commitment to improving the leisure facilities along the links. We hope by taking positive action we can help design out some of the problems caused by illegal encampments and fly tipping. We will continue to work with local groups to bring about sustainable development which will help Cambois retain its "Best Beach" status.

Once these exciting developments are underway, we will begin consulting on upgraded facilities for Jennings Field and look forward to working in partnership with NCC to make the most of our open spaces in East Bedlington.

Proposed new play facilities for Wembley



**Equipment List**

1. Kampion Double Balance Beam
2. Kampion Wobbly Balance Post (Set of 5)
3. Kampion Single Somersault
4. Kampion Nest Swing 100cm
5. Kampion Balance Poles

# Bedlingtonshire Community High School Update

To say we are 'excited' about our new school is an understatement. As the building rapidly progresses towards being complete there is a growing sense of anticipation about our new home. The building is progressing on schedule which means we will be handed the keys in late August 2016. Before then we have a lot of work to do including moving all our specialist ICT and Design Technology equipment.



The new build will give all our students an outstanding range of facilities as well as a bright, warm and secure environment to learn in. The new school enables us to continue to offer a rich and varied curriculum which meets the needs of all students. We believe this will support us in rapidly raising standards at GCSE and A Level as we have done so recently.

We shall continue to put the highest quality teaching and pastoral care at heart of everything we do, as we believe this enables happy students to achieve high standards.

In the coming weeks we shall continue to share images and news from the new school on our web site ([www.bchs.uk.net](http://www.bchs.uk.net)). If

you have any queries or questions then please do not hesitate to contact Mr Hinshaw (Deputy Headteacher).

Watch out for our new Alumni.  
This will be a great opportunity to contact old school friends.

## New Sport Centre

The school will have:-

- Top class 3G All Weather pitch
- 4 Court Sports Hall
- 24 station Multi Gym
- Dance Studio

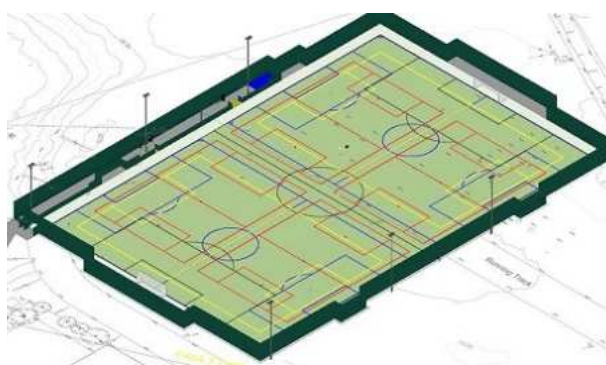

All these facilities will be available to students as part of their curriculum. Students will also be able to take part in a wide range of after school sporting activities. The facilities are also open to the community from 5.00pm each day.

## Opening Ceremony & leaving the old school

Opening a new school is not a regular event so we are currently planning a range of celebrations to mark the event.

There will also be opportunities for ex-students to visit the old school to say their goodbye's. Within weeks the old school will be demolished to create new pitches and outdoor spaces for students.



### Building work is well underway



### Staff member joins Parish Council

Andrew Allman who is the Parental Partnership Co-ordinator / Parent Liaison Contact at Bedlington Community High School has been appointed to the parish council.

The appointment will strengthen links between the school and the wider community.

Andrew will also take a key role in developing our Youth Parish Council over the coming months, enabling young people to have a say in how their parish develops.



## Facts and figures

- The total build cost is over £10.7 million
- The total internal area of the school is 6,500 m<sup>2</sup>
- There are 47 teaching rooms
- There are 7 Science rooms, 6 Design Technology rooms and 4 ICT labs
- There are 8 specialist SEN spaces. The school is fully compliant with current laws on Disabled access.
- The Dining area (internal) is 213m<sup>2</sup>. There is over 350m<sup>2</sup> of space for external dining.
- There is an open plan Library with seating for 30 students. Attached to this is a Sixth Form study room.
- There are 30 student toilets located in 3 separate blocks (1 ground floor and 2 first floor)
- The School Hall has bleacher seating capable of holding 240 students
- The entire school is covered by state of the art wireless access to support ICT



## New free Northumberland music event

The family festival – Northumberland Live in Bedlington has been born out of the runaway success of sister festival Northumberland Live that for the past two years has drawn big crowds to nearby Blyth



Johnny Hates Jazz

Headline acts **Johnny Hates Jazz** and **Modern Romance** will perform on July 16th in the beautiful setting of Gallagher Park, where families will be able to stay for the full day and even bring along a picnic. The groups had a string of smash hits in the 80's including 'Turn back the clock' and 'Best years of our lives' respectively.

Councillor Val Tyler, Cabinet Member for Arts, Leisure and Culture at Northumberland County Council said: "Northumberland Live in Bedlington promises to be great event. Events and festivals are a proven way of highlighting an area as being a great place to live, work or setup business; whilst also providing an opportunity for communities to celebrate together. "With live music, street theatre and family entertainment - it should be a day both for the residents of Bedlington and visitors to enjoy."



Modern Romance

The Event will run from 12 noon to 8pm and will feature a host of local supporting bands. The organisers have some other big announcements up their sleeves so watch this space!

To find out more about the event contact Mel Jackson on 07812 896482 or visit [www.facebook.com/NorthumberlandliveBedlington16/timeline](http://www.facebook.com/NorthumberlandliveBedlington16/timeline) or on Twitter @NlandLiveFest



**Saturday 27th August 2016**

from 12 noon— an amazing day of fun activities, rides & amusements, dancing, music , stalls, raffles, food & drink , tombola's—fun Dog Show for more information or to register to take part contact Jo Townsend on [townsendjo@sky.com](mailto:townsendjo@sky.com)

**Organised by Cambois Community Association**

# PARISH PLAN QUESTIONNAIRE 2016

Included in this edition you will find a copy of our parish plan questionnaire 2016. We would like you to take a few minutes to complete this giving us as much detail as you can.

East Bedlington Parish Council was the first of the newly formed councils in south east Northumberland to survey residents and form a Parish Plan in 2011.

**Why have a Parish Plan?** Parish Plans set out a vision for how a community wants to develop in the future. In identifying local problems and opportunities the community can then work with the council to implement the actions required to protect and improve the parish. Because they are holistic and comprehensive in their scope, they cover more than just planning issues, Parish Plans can include everything that is relevant to the community, including social, economic and environmental issues as well as planning related issues. The plan is a 'live' document and the actions are continually monitored.

**Why not a Neighbourhood Plan?** Neighbourhood Plans are primarily about the use of land and buildings. The purpose of Neighbourhood Plans are to enable development, to decide where and what type of development should happen in the local area and to promote more development than is set out in the Core Strategy. They cannot conflict with the strategic policies in the Core Strategy and they cannot be used to prevent development that is in the Core Strategy. Neighbourhood Plans carry more weight in the decision making process once they are formally adopted following a successful examination and a referendum but, they cost considerably more to produce—in excess of £20,000. The parish council believes this money is better spent carrying out the actions identified through consultation with the community rather than on an administrative process.

**How will we gather information?** Along with the survey we will be talking to young people and carrying out participative consultation at events such as Northumberland Live 2 in Gallagher Park and Cambois Gala.

**Do my views really count?** Yes they do! The information you provided during the first survey, along with partnership working has helped bring in over £900,000 of external investment to this parish. It has also helped keep the precept low for example in the last

survey 87% of respondents said that they were happy with the level of grass cutting. Based on this feedback the parish did not pay for additional cuts—a saving of £12,000 per year each year, to the electorate.

Need another questionnaire—download one from our website [www.eastbedlingtonpc.org.uk](http://www.eastbedlingtonpc.org.uk) or pick one up from the Parish Office.

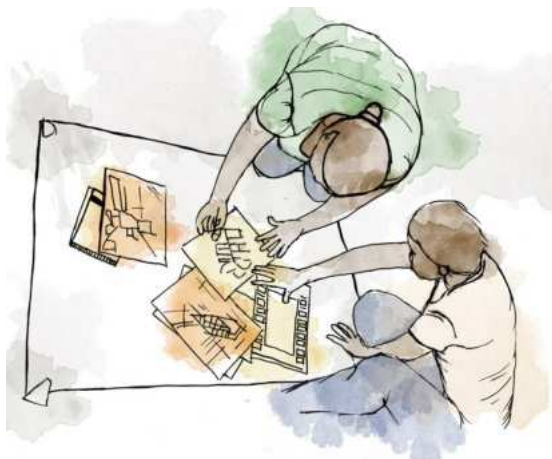

# What's on in the Station

## The South East Northumberland Stroke Support Group

A volunteer led group set up to help and support people living with stroke and their carers. We meet on the 3rd Monday of every month from 1pm to 3pm.

We have range of activities including speakers, bingo sessions, organised trips, domino's, board games and much more.

For more information about the group please call the secretary within office hours on 01670 712834 or 07791 628 144 or visit our website [www.strokesense.org](http://www.strokesense.org)

**New Venue**  
**St Johns Church Hall**  
**Bedlington Station**

## WOW! Fitness

**Monday Total Booty 6 - 7pm**  
**Concentrating on lower body, legs, bums & tums**

**Wednesday Meta Circuit 6 - 7pm**  
**Fat burning exercises, with a combination of arms, abs & all over body conditioning**

**Friday Cardio-Box 5.45 - 6.30pm**  
**Mixture of boxing & cardio exercises**  
**All classes £3.50**

**St Johns Church Hall, Bedlington Station**  
**For more information please contact Emma on 07803 730 339**



**During the refurbishment of East Bedlington Community Centre**

**We meet at**  
**St Johns Church Centre**  
**Bedlington Station**

**Every Sunday afternoon**  
**15:00 for tea & coffee**  
**15:30 meeting starts**  
**17:00 finish**

**For more information please visit our website**

**[www.hopechurchbedlington.co.uk](http://www.hopechurchbedlington.co.uk)**

## Hearing aid support in Bedlington

This service has temporarily relocated to

**Bedlingtonshire Medical Centre**  
(behind Morrisons)

- Re-tubing for NHS hearing aids (every 6 months)
- Or information on cleaning
- Or collecting new batteries (or returning old ones)

Drop in sessions are held on the **1st Monday** of every month (except Bank Holidays), at a new time of between **2pm and 3pm**

**For further information please call**

**01670 513606 or email:**  
**[Heartohelp.northoftyne@hearingloss.org.uk](mailto:Heartohelp.northoftyne@hearingloss.org.uk)**

# Free Energy Monitors & Boilers

East Bedlington Community Centre in partnership with Community Action Northumberland, NEA and British Gas still have free energy usage monitors for distribution into our community. The units which normally retail at £46 can help you to save up to £200 per year on energy bills. Anyone can have one—you don't need to be in receipt of benefits and there are no complicated forms to fill in.



The scheme is designed to really get you thinking about the energy you use and where you can make smart choices to improve your energy efficiency. NEA Action for Warm Homes also have a top 10 tips to stay warm and healthy in your home.

- 1) Improve energy efficiency
- 2) Register for priority services
- 3) Maximise your income
- 4) Check eligibility for discounts or support for energy bills
- 5) Check you are getting the best deal for your energy
- 6) Get Advice on managing bills
- 7) Use heating controls
- 8) Use hot water controls
- 9) Protect your home
- 10) Change your energy use behaviours

**More information on the top 10 tips is available on our website [www.eastbedlingtonpc.org.uk](http://www.eastbedlingtonpc.org.uk) or visit [www.nea.org.uk](http://www.nea.org.uk)**



## Could you qualify for a FREE Central Heating System?

### About the offer

Warm Up North, a partnership between nine North East local authorities and British Gas, has been awarded government funding to install FREE central heating systems into qualifying properties in the North East of England. You don't have to be a British gas customer to benefit from this offer. The full qualification criteria is shown below:

Qualification criteria (1-5)	
<b>1</b>	You are a private homeowner, or have a private landlord if you rent.
<b>AND</b>	
<b>2</b>	Your household has a gross total income of less than £26,000, including any benefits. You may still qualify if you receive certain income-related benefits. Visit <a href="http://www.warmupnorth.com/chf">www.warmupnorth.com/chf</a> for the full list of these qualifying income-related benefits, or call us on 0800 294 8073* to discuss.
<b>AND</b>	
<b>3</b>	You live in one of the nine Warm Up North areas: <b>Northumberland</b> ✓
<b>AND one of the following</b>	
<b>4</b>	i Your home does not have, and never has had, a central heating system. If you have electric storage heaters, electric room heaters, solid fuel fires and single gas fires, you may qualify as they do not count as central heating systems.
	ii The main method of heating your home is the use of solid fuels [1] and you only have a partial, solid fuel-fired, central heating system. By partial, we mean that one or more of your habitable rooms [2] are not connected to the home's main heating system.
	iii Your home uses electric storage heaters.
<b>AND</b>	
<b>5</b>	We want to install new central heating systems where they will make the most difference, particularly to the energy efficiency rating of homes. For you to qualify, the installation of a new central heating system must improve the energy rating of your home.

**Find out if you qualify by calling 0800 294 8073\***

# Reporting faults and problems

The following items are all the responsibility of Northumberland County Council who have introduced a new lo-call number to help reduce the cost of reporting. For all these matters please ring **0345 600 6400**. If you request the report reference number you can check on the progress of your complaint if you feel that nothing is happening. You can also report the problems online at [www.northumberland.gov.uk](http://www.northumberland.gov.uk)

- Street lighting (please take note of the column number as you will be asked for this)
- Highways—including road markings; gritting; pot holes; missing or damaged signage
- Blocked drains
- Dog fouling and stray dogs
- Street cleansing
- Fly-tipping
- Tree maintenance
- Anti-social behaviour
- Abandoned Motor Vehicles
- Minor localised flooding/blocked drains
- Nuisance parking
- Bin collections
- Graffiti removal
- Unauthorised waste carriers
- Noisy animals
- Illegal grazing

If your concerns have not been addressed within the specified timescale you can speak to your ward councillor who will be able to make enquiries on your behalf. You will find their contact details listed on page 24 of this publication . You can also discuss your concerns face to face with your county councillor. Cllr Jeff Gobin (Sleekburn Ward) holds a surgery on the last Thursday of every month at East Bedlington Community Centre from 6pm to 7pm.

A drop down list of issues that can be addressed by NCC is listed on this page simply click

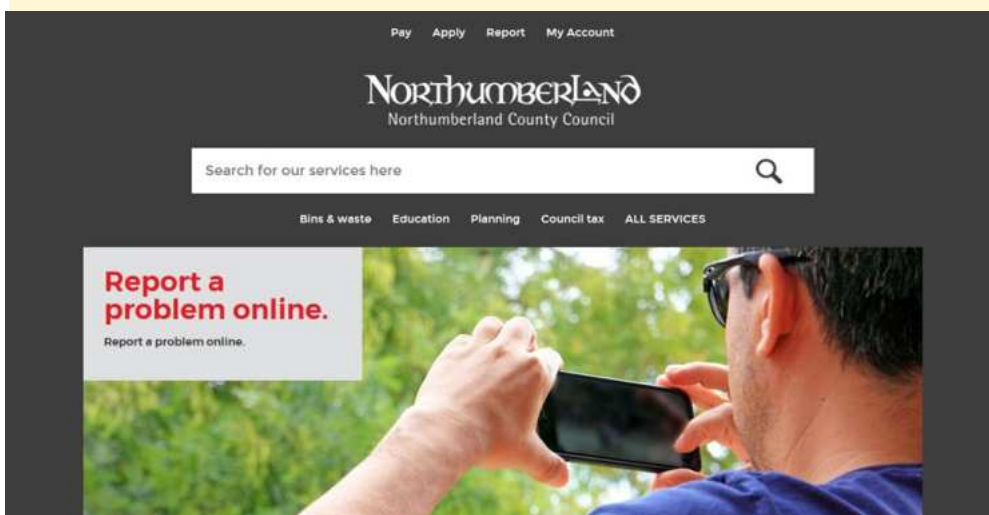

on the relevant report and add as much information as you can you will be sent a confirmation email and given a reference number to allow you follow up your complaint if necessary.



# Tackling litter & changing attitudes

In a recent press release Northumberland County Council Leader Grant Davy has stated that due to government cuts "residents will have to pay more but receive less."

This is not welcome news in a parish that is already significantly disadvantaged by high levels social and economic deprivation. The only investment to date in Bedlington East and Sleekburn wards since the creation of the Unitary Council has been brought about by the parish council.

To minimise the impact of further austerity measures it is clear that communities will need to be work closely with their local councils to make sure that they continue to receive the services that really matter to them.

Litter and dog fouling are the issues for which we receive most comments . In January the parish council carried out a bin survey and held talks with NCC Neighbourhood Services to establish how we can maximise the time that the cleansing teams now have to carry out bin emptying, use of the mini sweeper and litter picking.

Currently the parish has over 4000 household waste bins, 4000 household recycling bins and 89 public bins of various shapes and sizes. Commercial traders have

their own waste collections. With so much provision it is hard to imagine why we have a problem with waste and the dreaded dog pool!

The law has not changed ... if there is not a bin handy you should **take your rubbish home**—this includes your bagged dog waste! Don't leave it lying on the ground and don't use the filled bag to decorate trees and shrubs.



The Council do not put dog foul on beaches, leisure areas, playing fields or footpaths. The problem is caused by negligent owners who have no respect for the environment or others in their community.

In the coming weeks we will be replacing some of the lamp post mounted bins with large free standing bins. We will measure the impact this

has on freeing up time for the NCC operatives to concentrate on litter picking and getting the mini-sweeper out and about. We have specific days when the cleansing team are in our parish these are:

AM Monday, PM Tuesday, All day Wednesday  
All day Thursday, AM Friday—which will also be the day when the operatives will collect reported fly tipping from around the parish.

## CHURCH LAUNCHES LIFE-SAVING SERVICE FOR PEOPLE IN DEBT



PEOPLE stuck in the debt trap can now get free help thanks to a local church opening a Debt Help centre.

Hope Church Bedlington is partnering with national charity Christians Against Poverty to bring its award-winning service to South East Northumberland. It follows the recent “What Hurts Most” survey by the church which revealed that debt and financial worries were one of the top concerns for people in the area.

The new CAP Debt Centre is available for anyone living in the Bedlington, Ashington, Morpeth, Blyth and Cramlington areas. There is no need to be

religious or have a connection with the Church to benefit from the in-depth, face to face service that CAP provides.

Bedlington Centre Manager Kay Fancett said: “The Church has always been about offering hope and we're really pleased to be able to give a tried-and-tested route out of debt. In our society a lot of poverty is debt-related, so Hope Church has been working hard to get our new CAP centre so we can help get people back on track.”

CAP offers people a uniquely in-depth, caring service to people with spiralling personal debt regardless of their age, gender, faith or background. Every client is visited in their own home, the charity does all the negotiating with creditors and local volunteers offer support to each person face-to-face until the day they are debt free.

Statistics show that one in three callers seeking debt help are feeling suicidal but find huge relief through the non-judgemental service that treats every person as an individual.

Kay added: “Typically, debts can build up when a relationship breaks down, or someone loses their job, or through bereavement – so often when people are least able to cope with a financial headache.”

Anyone wanting help should phone

0800 328 0006. The call is answered at CAP’s Bradford office and the trained staff will make an appointment for volunteers from the Bedlington centre to visit you.

Wansbeck MP Ian Lavery with Kay Fancett, Bedlington CAP Centre Manager, at the launch of the new Bedlington Debt Centre.



# War Time Bedlington continued...

## 1ST JULY 1916—A DARK DAY FOR BEDLINGTON

Lord Kitchener's recruiting poster with the pointing finger and the slogan "YOUR COUNTRY NEEDS YOU" was a success in World War 1, but another of his recruiting strategies wasn't thought through and was to have disastrous consequences for towns and villages throughout the country. For communities in Northumberland and Durham the disaster occurred on the first day of the Battle of the Somme.

Kitchener's idea was for Pals Battalions, which encouraged men who lived and worked together to go and fight together. Evidently no one considered that men who fought together would also die together. The Northumberland Fusiliers raised 10 Pals Battalions. The two Tyneside Commercial Battalions (18<sup>th</sup> and 19<sup>th</sup>) were raised mainly in Newcastle, the four Tyneside Irish Battalions (24<sup>th</sup>-27<sup>th</sup>) were raised largely from the Roman Catholic community and County Durham, and the four Tyneside Scottish battalions (20<sup>th</sup>-23<sup>rd</sup>), which initially targeted men of Scottish descent, consisted largely of men recruited from the coalfields of South East Northumberland.

The following information about the Battle of the Somme I have learned from 'Tyneside Scottish' by Graham Stewart and John Sheen, which provides detailed information about the four Tyneside Scottish Battalions in the Great War.

The Tyneside Scottish began recruiting in October 1914, There were at least 1,000 men in each battalion, with another 250 in each reserve depot company, and Bedlington was one of their most prolific recruiting areas. Mr. C. A. Nicholls, manager of the Prince of Wales Picture House, recruited 350 men and was commissioned into the 23<sup>rd</sup> Battalion, but not everyone from Bedlington enlisted in the town so the total was probably much higher. The recruits spent all of 1915 training, and went to France in January 1916, doing their final training at Flerbaix, a quiet area where new troops could get acclimatised to trench warfare. They reached the front line trenches on 17<sup>th</sup> February, where 'no man's land' between the British and German trenches varied from 50 to 400 yards. They had to battle not only with the Germans but also with cold, rain and lice. After a couple of months in the cycle of being in the front and reserve trenches, they marched south for three days to the Somme valley, and this is where they had their first experience of constant shelling by day and night.

To this nightmare landscape were added tunnelling parties digging under the enemy trenches to lay mines, and raiding parties crossing 'no man's land' to find out the enemy's plans. In late June a German spy dressed as a Tyneside Scottish officer was arrested in the British trenches, but unfortunately it later turned out that the officer to whom he was handed over was also a spy. The original attack in the Somme Valley was planned for 29<sup>th</sup> June, but was delayed for 2 days due to bad weather, so 1<sup>st</sup> July 1916 was set as the day on which the Tyneside Scottish and Tyneside Irish would attack the Germans.

Each man was to carry

Rifle, bayonet and equipment	2 extra bandoliers of ammunition
2 Mills grenades	Rations for the day and mess tins
Haversack and waterproof cape	4 sandbags
2 gas helmets	Either a pick or a shovel
Full water bottle	

Bomb buckets, bomb waistcoats and wire cutters were to be shared within each company

And there had to be a yellow triangle on each man's back so that the artillery didn't shoot their own men. It has been estimated that each man was carrying 70 lb of equipment *continued over*

The signal for the advance was the detonation of mines under the German trenches, and the men then had to WALK across muddy ground strewn with barbed wire, with the second and third waves crossing planks at intervals over their own trenches before they could reach the front.

And they didn't stand a chance because the Germans knew they were coming.

The aim of the attack was to capture the village of La Boisselle. Brigade headquarters received a message of good luck to be forwarded to the front line troops, but thinking that the message might not reach the front in time if sent by messenger, one of the staff officers sent it by telephone or telegraph. The German listening post in La Boisselle picked up the message, so they were ready..

The mines were detonated at 7.28 a.m. and a few minutes later the Tyneside Scottish, led by their pipers, advanced straight into machine gun fire, and those who survived this were shelled by the German artillery, with the ground turning into a quagmire. All four Battalion commanders were killed, and every officer and sergeant of the 20<sup>th</sup> Battalion who went over the top became a casualty, leaving the Battalion leaderless.. At the end of the day only 120 men of the 23<sup>rd</sup> battalion answered their names. As darkness fell the stretcher bearers rescued as many as they could, but the next day the shelling began again. Other regiments were ready to take over, but the Tyneside Scottish were told to hold the line for another day.

Initial reports gave casualty figures of 475 killed, 489 missing and 1,474 wounded, making 2,378 casualties from about 4,000 men. The 1921 figures, which include the missing as 'presumed dead' gave figures for 20<sup>th</sup> Battalion 353 killed and 278 wounded

for 21<sup>st</sup> Battalion 172 killed and 306 wounded

for 22<sup>nd</sup> Battalion 205 killed, 333 wounded and 1 missing

for 23<sup>rd</sup> Battalion 187 killed, 451 wounded and 2 missing

Of the 82 men on the memorial in St John's whom I have so far identified, 21 died on the first day of the Battle of the Somme, with 9 belonging to the 20<sup>th</sup> Battalion and 6 to the 23<sup>rd</sup>.. Of these 21 men only 4 have known graves, all being buried in Ovillers cemetery. The names of the other 17 are included in the 72,000+ names on the Thiepval Memorial because their bodies were either never found or could not be identified. Almost every military cemetery for World War 1 includes some (often many) headstones bearing the inscription 'A SOLDIER OF THE GREAT WAR KNOWN UNTO GOD', and the soldiers' names probably appear on a nearby memorial, for there was no way of identifying them when their identity tags were lost. I had always presumed that men weren't identified because they had been blown up, but many of the Tyneside Scottish weren't identified simply because they were miners, as John Sheen explains in his book 'Tyneside Irish'. When working underground the miners were given tokens to identify which tubs they had filled, and they would attach these to their braces while working. The soldiers' identity tags were roughly the same size as these tokens so they were attached to braces instead of being worn around the neck. This became a problem when the soldier was killed, for the burial party would open the neck of the tunic to remove the identity disc, and if they didn't find it they didn't look elsewhere, they just added that body to the list of the unknown.

Of the 21 men on the Memorial in St. John's those buried in Ovillers Cemetery are

Pte. William Hall 24<sup>th</sup> Battalion (Tyneside Irish) aged 23, of South Row

Pte. William Jamieson 21<sup>st</sup> Battalion aged 28, of South Row  
His brother Robert was killed 6 months later

Pte. Francis Johnson 20<sup>th</sup> Battalion aged 42, of Routledge's Buildings

Pte. William Latty 23<sup>rd</sup> Battalion aged 19, of South Row

William was the eldest son. His youngest brother was killed in Normandy in 1944 and is also on the Memorial.

## Those named on the Thiepval Memorial are:

Pte. Joseph Bailley	21 <sup>st</sup> Battalion	aged 39, of Back Clayton Street
L/Cpl. Robert Chilton	20 <sup>th</sup> Battalion	aged 34, of Whitley Terrace
L/Cpl. Philip Clark	22 <sup>nd</sup> Battalion	aged 35
Sgt. Robert Cockburn	20 <sup>th</sup> Battalion	aged 21, of North Row
Sgt. William Cram	23 <sup>rd</sup> Battalion	aged 32
L/Cpl. Thomas Doyle	2 <sup>nd</sup> Royal Inniskilling Fusiliers,	aged 27, of North Row probably attached to the Tyneside Irish at the time of the battle
Pte. James Dunbar	21 <sup>st</sup> Battalion	aged 27, of Jubilee Terrace
Pte. John Ferrier	23 <sup>rd</sup> Battalion	aged 24, of Hirst Terrace. His brother George was killed two months later and is also named on the Thiepval memorial
Pte. William Flockhart	20 <sup>th</sup> Battalion	aged 31, of South Row His brother James who had married and moved to Ashington died with the 23 <sup>rd</sup> Battalion on the same day and is buried in Ovillers Cemetery
Pte. Robert Ince	23 <sup>rd</sup> Battalion	aged 33
Pte. Christopher Jefferson	20 <sup>th</sup> Battalion	aged 33, of South Row His brother Henry serving with the D.L.I. died in October 1918
Pte. George Kinghorn	20 <sup>th</sup> Battalion	aged 39, of Pioneer Terrace His brother Thomas, serving with the 1 <sup>st</sup> Bn., died April 1917
Pte. Nicholas Knox	23 <sup>rd</sup> Battalion	aged 19, of Ravensworth Terrace
Pte. John W. Richardson	20 <sup>th</sup> Battalion,	aged 27,
Pte. William Robson	23 <sup>rd</sup> Battalion	aged 19, of North Row
Pte. Henry Routledge	20 <sup>th</sup> Battalion	aged 34, of Hornby House, Bedlington Station
L/Cpl. William Southern	20 <sup>th</sup> Battalion	aged 20, of Victoria Terrace

The Bedlington Enlistment Book in St Cuthbert's gives an indication of the men from the Top End who died on the 1<sup>st</sup> July, a number which I reckon to be at least 5 with graves in Ovillers cemetery and 34 named on the Thiepval Memorial.

The 21 names on the St John's Memorial are the men from Bedlington Station who died that day, and there others who were wounded and died in the following weeks, but we don't know how many returned wounded, or whether they were able to go back to their old jobs, and what effect that had on their families. Many of those who enlisted were hewers, who earned the highest wages, and it is doubtful whether any man who had been wounded would ever be strong enough again to do a hewer's job.

The families whose men were buried at Ovillers at least had some closure in the weeks after the battle. Reading the *Blyth News* of March 1917 I came across entries such as "Private William Jamieson, eldest son of Mr and Mrs Wm. Jamieson of 79, South Row, Bedlington Colliery, missing since July 1<sup>st</sup>, is now officially reported as Killed in Action." All that these families had received in July was a telegram to say that their husband or son was missing, and they had to wait eight or nine months until he was 'presumed dead'. It is no wonder that some wives and mothers refused to have their man's name on a memorial, believing that the authorities didn't really know what had happened to him.

*Research and story provided by Carole Fife*

## Can you help the Matthew Project Foodbank?

As more and more families are suffering from hardship, demand is growing on the foodbanks.

Donations of non perishable food such as long life milk, breakfast cereals, flour, tinned foods, pasta, rice, biscuits, tinned vegetables, sauces, tinned fruit, tuna, hot dogs, tea, coffee, sugar, jam and instant mash are gratefully received.

The Matthew Project will also welcome toiletries, sanitary products, nappies, toilet rolls and cleaning materials.

Donations can be left at East Bedlington Parish Council Office or you can make arrangements for collections by contacting Mike Clark on 01670 829062 or email [mclark095@gmail.com](mailto:mclark095@gmail.com)



## Church Services in the Parish

**St Andrew's Church**  
Unity Terrace  
Cambois

**St John's Church**  
North View  
Bedlington Station

**Sunday 10.30 Holy Communion**  
**Wednesday 10.45 Holy Communion**

**Sunday 9am Holy Communion**  
**Thursday 10.15am Holy Communion**

All age worship at St Andrew's is  
4th Sunday of the month at 10.30am

All age worship at St Johns is the 2nd  
Sunday of the month at 10am

**Parish Office Hours**

**Every Thursday**  
**From 1pm—2pm**

**Contact:**

**Rev'd Ian Hennerbry 01670 822309**  
**Rev'd Elizabeth Brown 01670 515556**

# Your Councillors



**Councillor Alex Wallace**  
Chairman  
☎ 01670 822858



**Councillor Allan Stewart**  
Vice Chairman  
☎ 01670 826025



**Councillor Nichola Hogarth**  
☎ 0770 931 6617



**Councillor Andy Watson**  
☎ 0779 556 8369



**Councillor Eddie Dickson**  
☎ 01670 826527



**Councillor David Graham**  
☎ 01670 828907



**Councillor Joe Dobie**  
☎ 01670 824113



**Councillor Andy Allman**  
☎ 07717 420566



**Councillor Keith Grimes**  
☎ 07855 711813

I am a retired engineer. I spent my career in mining, power generation, and latterly the oil and gas business.

I am a strong believer in local government and believe it exists solely to serve and support the community, particularly the vulnerable and disadvantaged.

As an avid beekeeper, and current chair of the Alnwick and District Beekeepers Association, I am a passionate advocate for the environment.

I get particularly agitated at the sight of littering, dog fouling ( I have three dogs of my own), fly tipping and graffiti.

**Councillor Allan Douglas**

☎ 01670 829078

I am a retired Care Worker and have been married to my wife Muriel for nearly 50 years. We have a son, daughter and 2 grandchildren. I have previously worked as an electrician, plastics technician, power worker and docker.

My interests include music - Country & Western and Rock & Blues—I was a drummer in a Rock and Blues band throughout 60's . I also enjoy reading — currently the history of the American and Spanish Civil Wars.

I was a Wansbeck District Councillor for 28 years, where I was chair of Personnel, Chair of Planning and Executive Member for Housing. I was also vice-chairman of the National Association of Councillors for Great Britain.

It is my aim to do my best to improve the quality of life for people living in East Bedlington.



## Your Parish Team

Ron Thornton

Parish Clerk & Responsible  
Financial Officer

clerk@eastbedlingtonpc.org.uk

Mobile: 0752 842 8609



Jenny Tindale

Assistant Parish Clerk

jennytindale@btconnect.com

Mobile: 07900 683 675



## Parish Office

East Bedlington Parish Council

Parish Office

16 Station Street

Bedlington

NE22 7JN

☎ 01670 828808

[www.eastbedlingtonpc.org.uk](http://www.eastbedlingtonpc.org.uk)

Normal opening hours

Monday to Friday

10am to 12 noon

2pm to 4pm

## Your Northumberland County Councillors

Councillor Valerie Tyler

Bedlington East Ward

01670 825252

Councillor Jeff Gobin

Sleekburn Ward

01670 822539

### MP

Ian Lavery MP

Wansbeck Constituency

7 Esther Court, Wansbeck Business Park,  
Ashington, NE63 8QZ

Tel: 01670 852494

Email: [ian.lavery.mp@parliament.uk](mailto:ian.lavery.mp@parliament.uk)

## About East Bedlington

The Parish serves the communities of North Blyth, Cambois, East Sleekburn, Bedlington Station and East Bedlington. The Parish consists of two wards, Sleekburn and Bedlington East and has some of the highest levels of economic and health related deprivation statistics in the UK. The Parish is represented by 11 Councillors whose details can be found on page 23 of this publication and the Parish website [www.eastbedlingtonpc.org.uk](http://www.eastbedlingtonpc.org.uk)

## Meetings

The Parish Council meets on the 1st Tuesday of each month at 6.00 pm (with the exception of August) at its office on Station Street.

The first 15 minutes of each meeting is allocated to members of the public who can raise issues and comment on the business to be conducted